

TRANSFORM YOUR LIFE

Godrej interio®

GET A ONE-UP IN **STORAGE**



STORE UP



FEATURES

- **Optimized Storage Space**

This aesthetically appealing, hassle-free and ergonomically designed storage unit makes optimum utilization of your office storage space and exploits your space's true potential.

- **Corner Storage**

Store Up utilizes the corner spaces in your office which doubles your existing storage space and enables optimum utilization of your office's storage space.

- **Endless Configuration**

Store up can be installed in an unending line up with no limit to the number of main plus add on bodies.

- **Sturdy Unit**

Store up is made of a sturdy metal carcass structure.

- **Wooden Shutters**

Store Up comes with simple yet suave wooden shutters which lend a softer look to your workspace. These are available in a variety of shades to fit right into your office space.

DIMENSIONS

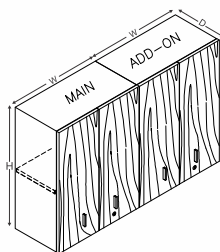

Size	W	D	H
300	326	785	
450	326	785	
600	326	785	
800	326	785	
900	326	785	

Size	W	D1/D2	H
W1	600	326	785
W2	318		
W3	300		

Note:
Need to be mounted on true wall only

CORNER UNIT

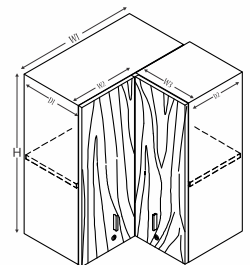

COLOUR OPTIONS



SESAME BEIGE BODY WITH
MODISH OAK FASCIA

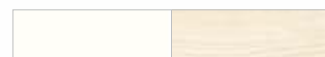

BOND WHITE BODY WITH
HIGHLAND PINE FASCIA

*All dimensions are in mm



Godrej Interio
Has been awarded Asia's Most Promising Brands 2012-13
Process Advisors & Evaluators - KPMG in India



An initiative by Godrej Interio
 1st Indian furniture company with GREENGUARD Certified products

MODULAR FURNITURE | DESKING | SEATING | STORAGE | INTERIORS | LAB | MARINE | HEALTH CARE | HOME



NATIONAL:

North: Delhi, Chandigarh, NCR, Lucknow

South: Chennai, Bengaluru, Hyderabad, Kochi

West: Mumbai, Ahmedabad, Bhopal, Pune

East: Kolkata, Bhubaneshwar, Guwahati, Patna

INTERNATIONAL: Sharjah (UAE), Riyadh (Kingdom of Saudi Arabia)

LOCAL ADDRESS

In keeping with the Godrej policy of continuous development and improvements, the dimensions and specifications may be changed without prior notice or obligations. All dimensions are in mm and are subject to commercial tolerances. Colour options depicted in this catalogue are as close to what modern printing processes allow.

Godrej & Boyce Mfg. Co. Ltd.

Godrej Interio, Plant 13A, Pirojshanagar, Vikhroli (E), Mumbai - 400 079. Toll Free Number: 1-800-267 1122

Fax: +91-22-6796 1503. Website: www.godrejinterio.com | Email: interiooffice@godrej.com

Follow us on [in](#) /Godrej-interio [t](#) /Godrejinterio4U [v](#) /GodrejInterio [f](#) /GodrejInterio

Our products are meant for Indoor usage only.